

## Part List

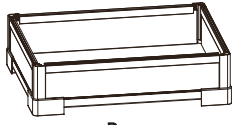

Base



Top Frame

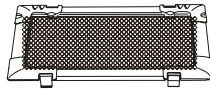

Top Cover



Glass Lock  
(already assembled in the base)



Suction Cup



Cable Pass



Screwdriver

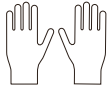

Gloves

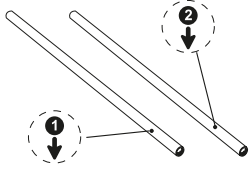

Front Tubes (2)

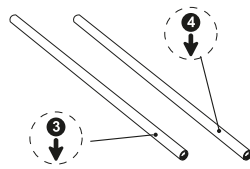

Back Tubes (2)

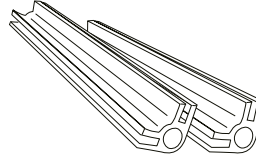

Back Supports (2)

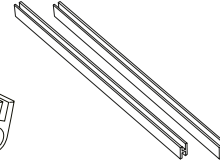

H-Slots

- Glass Terrarium L <30 in., H-Slots, 1 pce.
- Glass Terrarium L ≥30 in., H-Slots, 2 pcs.
- Fresh Air Terrarium, H-Slots, 2 or 3 pcs.

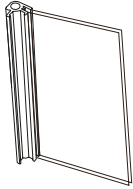

Glass Doors  
Single Door, 1 pce.  
Double Door, 2 pcs.

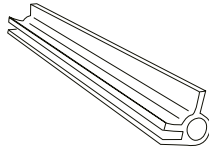

Front Supports  
(Only for single door terrarium)



Screws (4)



Cable Hole Covers (6)  
(already assembled on the top cover)



Rubber Caps (4)

### Side glass or ventilation mesh (Following are the combinations)

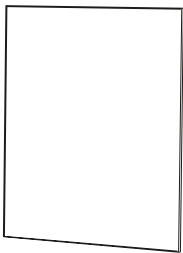

or

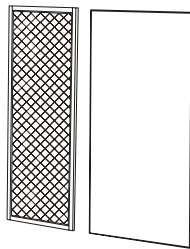

**Remark:** There are many combinations of terrarium's left / right / back side. Specific type is subject to actual product.

### Back Glass



or

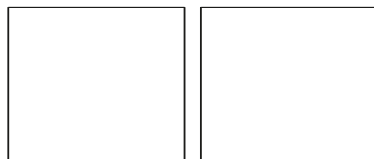

- Glass Terrarium L <30 in., Back Glass, 1 pce.
- Glass Terrarium L ≥30 in., Back Glass, 2 pcs.

**Remark:** There are many combinations of terrarium's left / right / back side. Specific type is subject to actual product.

## Assembly Instructions

1. Screw the 4 numbered metal tubes into the appropriate holes on the base as shown here.

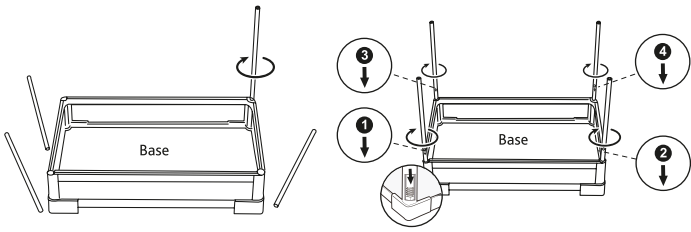

2. Install the 2 back supports of the terrarium. Next, install the labeled glass doors on the appropriate side as shown here.

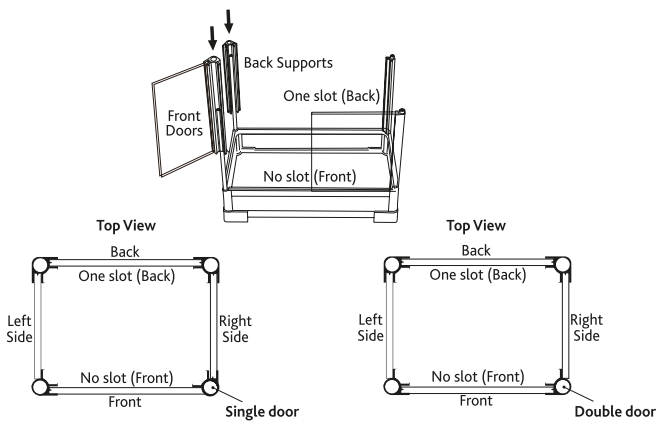

3. Install the back glass. Now, install the side glass panels. If you are using the metal ventilation + glass, install glass and mesh ventilation, then slide the H-slot to connect the 2 pieces.

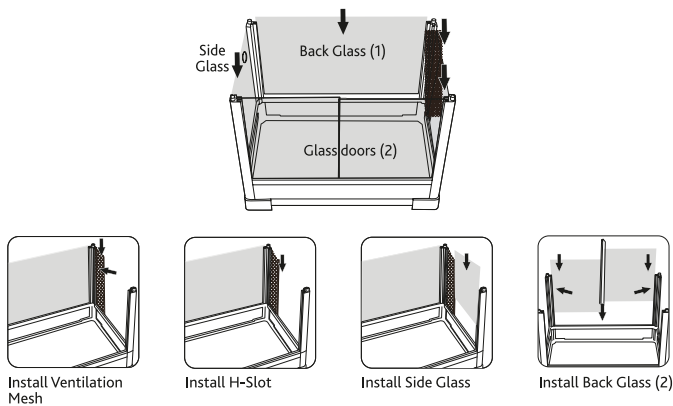

4. When all four sides have been installed, place the top frame without the ventilation mesh, on top of our terrarium. Make sure the frame sits properly in the tracks.

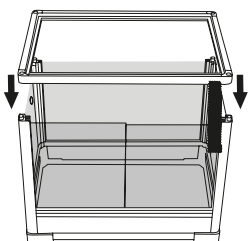

5. Using the provided screw driver, firmly screw the screws into the metal tubes. Next, use the key and lock the front glass doors.

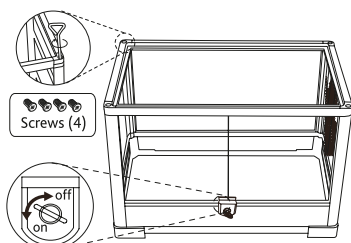

6. Split one full set into 3 separate parts.

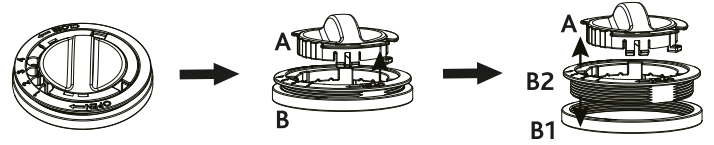

7. Put B1 outside of the terrarium and B2 inside of the terrarium and then rotate B2 clockwise.

8. Please align the arrow and install A into B.

9. Please follow the direction "CLOSE" and rotate to lock.

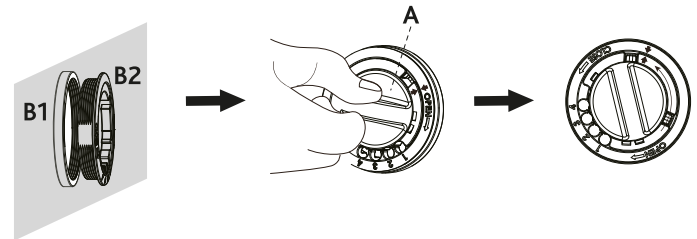

10. Install the top metal ventilation mesh and the 4 rubber caps to cover the screws.

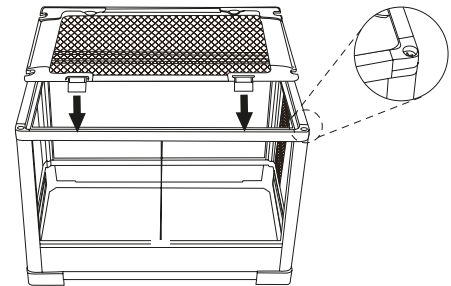

11. Install the cable hole covers.

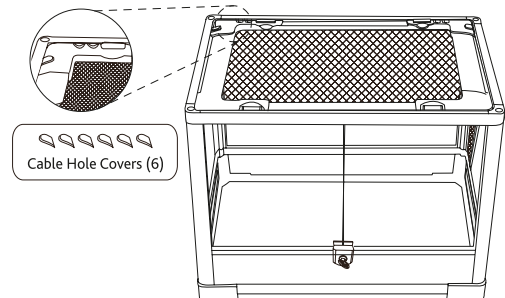

### WARNING

The distance between the plastic frame on top of the terrarium to the edge of the heat lamp metal dome must be a minimum of 1.5 in. This is to prevent the burning of the plastic frame from the heat of the lamp metal dome. (Heat lamp not included.)

